

INSTALLATION NOTE

THIS LED LIGHT KIT INCLUDES TWO DISTRIBUTION BLOCK MOUNTS

Use the smaller Distribution Block Mount with the Distribution Block included in this kit.

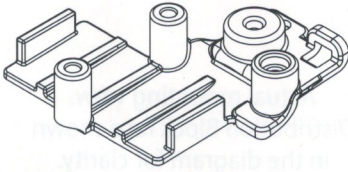

To install the included distribution block on your Land Rover® Defender®: Follow the instructions on the included LED Light Kit Installation Instructions sheet for basic installation of this LED light kit.

Use the larger distribution block mount for installation of the Pro Scale® Lighting Distribution Block (included with part #6591, sold separately).

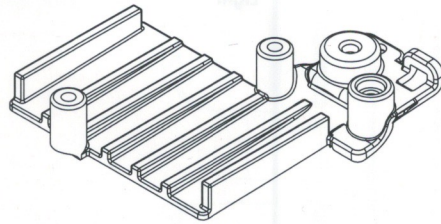

To install the Pro Scale® Advanced Lighting Control System (part #6591, sold separately) on your Land Rover® Defender®: Follow the instructions on the included LED Light Kit Installation Instructions sheet, but *replace the Distribution Block Installation section with the instructions below.*



Visitez Traxxas.com/manuals pour télécharger les instructions dans votre langue.
 Visite la página Traxxas.com/manuals para descargar el instrucciones en su idioma.
 Auf Traxxas.com/manuals, können Sie anleitung in Ihrer Sprache downloaden.

Pro Scale® Advanced Lighting Control System (#6591) Installation Instructions - Land Rover® Defender®

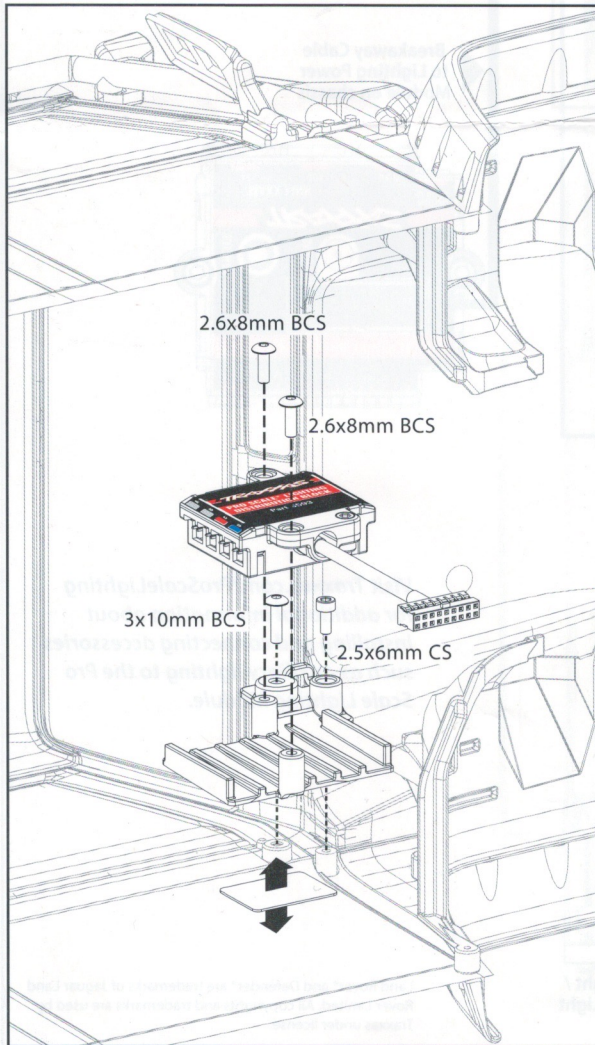

Distribution Block Installation

1. Remove the 2.5x6mm cap screw and the 3x10 mm button-head screw from the driver side (left side) mirror retainer. Replace the mirror retainer with the included distribution block mount and secure the mount and side mirror with the two removed screws as shown.
2. Plug all LED light wire harness connectors into the ports on the Pro Scale Distribution Block. Match the color band and/or letter indicator on the wire harnesses with the corresponding color/letter of each port on the distribution block (see chart below for more detail).
3. Use the included 2.6x8mm button-head screws (2) to secure the distribution block to the mount.

Distribution Block LED Light Harness Ports

Accessory Connectors (not used with this kit)

Wiring connectors for the lights are labeled with letters and/or colors.

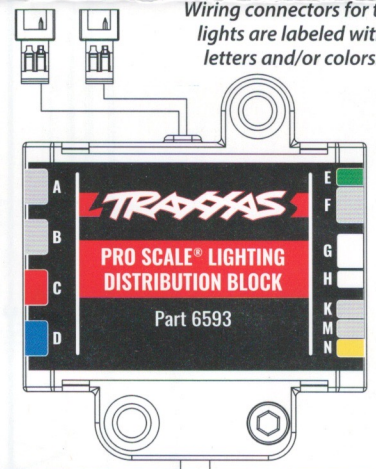

Letter	Description	Function
A	Reverse light harness	Back up light LEDs when vehicle is put in reverse
B	Rear turn signal harness	Rear turn signal LEDs
C	Tail light harness	Tail lights, brake lights, and rear integrated turn signal LEDs
D	Rear side marker harness	Rear side marker LEDs (if equipped)
G	Head light assembly harness	Headlights, front marker light LEDs, and side marker light LEDs
H	Front turn signal harness	Front turn signal light LEDs
K	Rear high brake light harness	High brake light LEDs
M	Light bar high/low harness	LED light bar that typically mounts to the roof of the vehicle
N	Rock lights assembly harness	Accessory LED lighting that mounts to the vehicle body

TRAXXAS.COM

Traxxas, 6250 Traxxas Way, McKinney, TX 75070, Phone: 972-549-3000, Fax: 972-549-3011, e-mail: support@Traxxas.com

HKC21019-R00 Rev 210628

Body Wiring (viewed from the underside of the body)

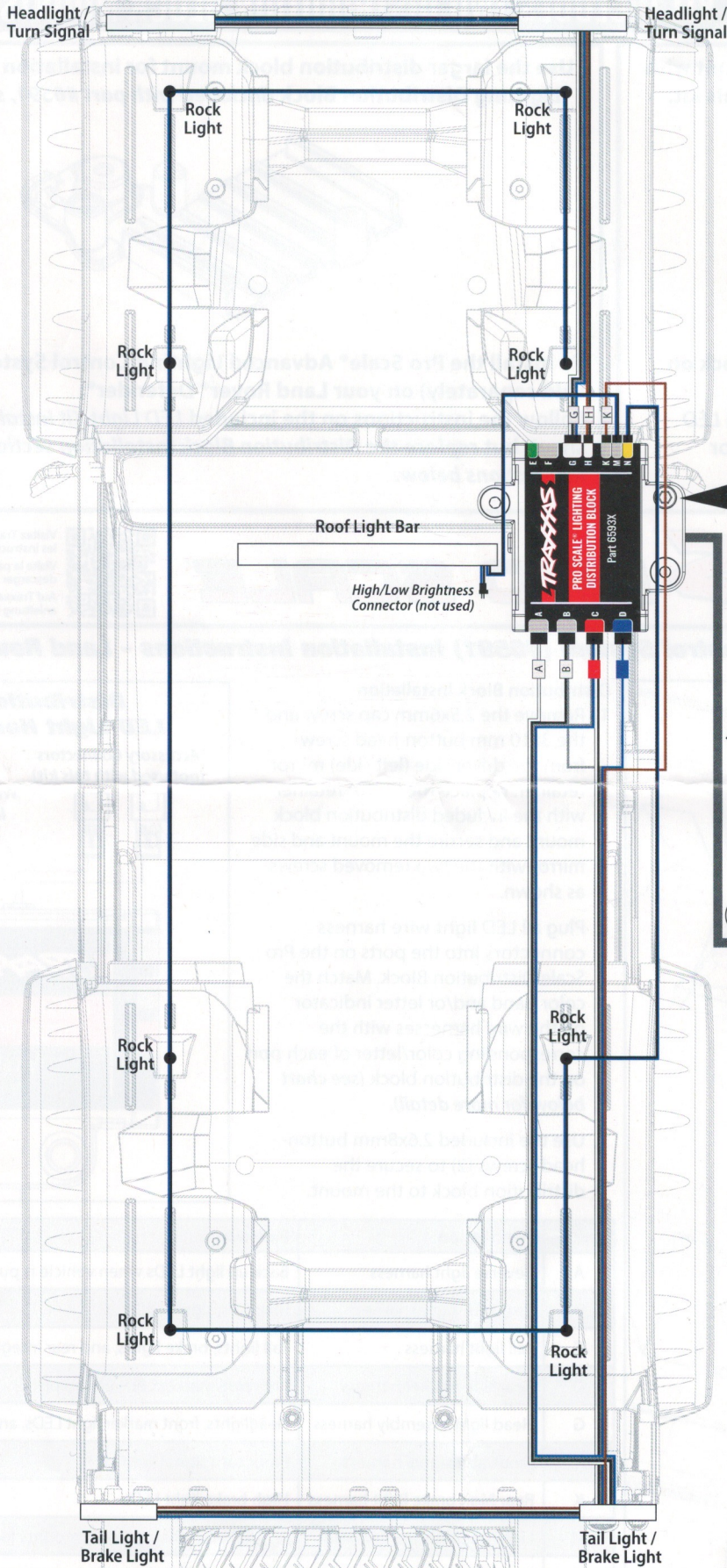

Actual mounting view.
Distribution Block face shown
in the diagram for clarity.

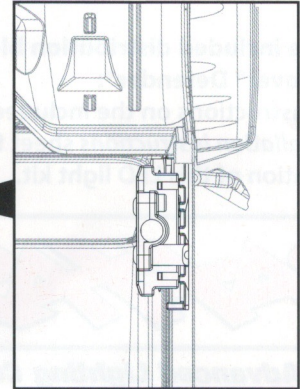

Breakaway Cable to Lighting Power Module on chassis

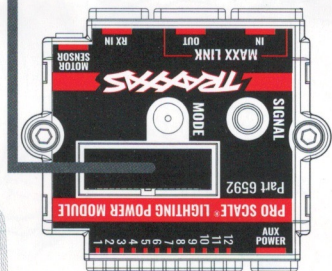

Visit Traxxas.com/ProScaleLighting for additional information about installing and connecting accessories such as auxiliary lighting to the Pro Scale Lighting Module.

Land Rover® and Defender® are trademarks of Jaguar Land Rover Limited. All copyrights and trademarks are used by Traxxas under license.

TRAXXAS.COM

Traxxas, 6250 Traxxas Way, McKinney, TX 75070, Phone: 972-549-3000, Fax: 972-549-3011, e-mail: support@Traxxas.com